

For Immediate Release



Competitive Social Ventures Breaks Ground On Third Fairway Social Location

The third location will be located at Urban Supply in Birmingham, AL

ATLANTA – June 18, 2024 – [Competitive Social Ventures](#) (“CSV”) today announced it’s breaking ground on its third Fairway Social location. Located at Urban Supply, a multi-block destination in Birmingham’s Parkside District, the build is expected to take 4 to 6 months for completion with the location expected to open later this year.

The new location will be approximately 7,500 square feet and will have a full-service restaurant and bar, a total of seven Full Swing™ powered bays and outdoor gathering spaces. Fairway Social Birmingham will also feature a mega entertainment wall for live sports, live-music, darts, cornhole, ping-pong and more.

“We are excited to continue growing the Fairway Social brand with the addition of a Birmingham location,” said Neal Freeman, CEO of Competitive Social Ventures. “Fairway Social is a versatile brand that appeals to avid golfers, social seekers and everything in between. We are excited to be a place of connection in Birmingham’s Parkside District.”

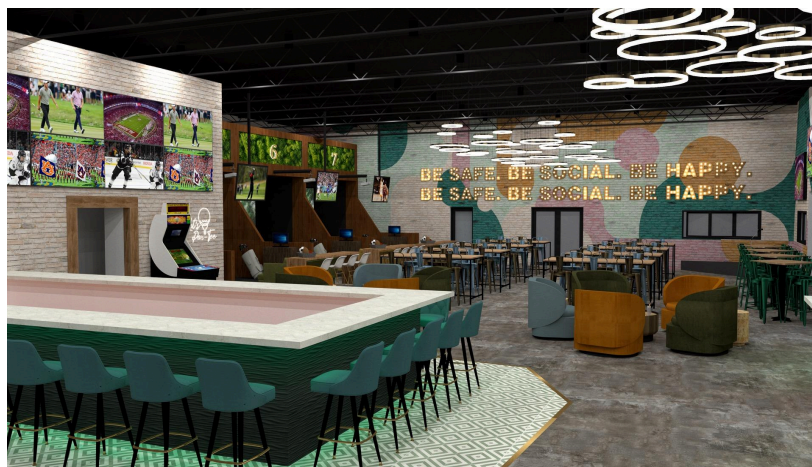

Fairway Social Birmingham (Rendering By The 2nd Star Group)

Urban Supply consists of six properties along a pedestrian-only aisle created from a former alley. Once complete, this area will feature entertainment, food and beverage, fitness and office

spaces. This historic tax credit project connects Birmingham's minor league baseball stadium and Railroad Park to a variety of newly constructed residential buildings. Currently, Fairway Social has locations in Alpharetta, GA at The Maxwell and at Trilith Town Centre in Fayetteville, GA.

CSV is a leader in socially-driven entertainment concepts and is equipped with highly experienced hospitality, food and beverage executives. Backed by a strong track record in the hospitality space, CSV currently owns and operates four successful entertainment venues in Georgia across its portfolio of brands - [Fairway Social](#), [Roaring Social](#), and [Pickle and Social](#).

CSV offers opportunities to strategically partner with the upcoming Fairway Social Birmingham location, or holistically with CSV's portfolio of brands and locations.

To learn more about Competitive Social Ventures, please visit www.competitivesocialventures.com. To learn more about Fairway Social, please visit www.fairway-social.com. For information on partnership opportunities with CSV, please visit www.competitivesocialventures.com/investors.htm.

###

About Competitive Social Ventures

Founded in 2020 and headquartered in Alpharetta, GA, Competitive Social Ventures ("CSV") is a hospitality company that creates socially-driven entertainment concepts including Pickle and Social, Fairway Social and Roaring Social. CSV creates premier entertainment venues that bring people together to socialize, enjoy premium food and beverages, and create one-of-a-kind shared experiences. CSV currently operates Pickle and Social Gwinnett, Roaring Social Alpharetta, Fairway Social Alpharetta and Fairway Social Trilith (Fayetteville) in Georgia. Learn more at www.competitivesocialventures.com. For partnership opportunities, see [here](#).

About Fairway Social

Fairway Social is the ultimate destination for world-class virtual gaming, chef-curated dining, live music and uniting families and friends of every age and skill level. Fairway Social offers a selection of virtual games including golf and non-golf games for an immersive experience that is combined with premium food and beverage. Fairway Social is powered by Full Swing golf simulator technology, the same simulator used by Tiger Woods, John Rahm and Jordan Spieth for off-the-course practice. Fairway Social currently operates in two locations in Georgia: Alpharetta and Trilith (Fayetteville). Learn more at www.fairway-social.com or follow us on Instagram [@fairwaysocial](#). [#BeMoreSocial](#)

Media Contact:

Qilafi Public Relations
Brooke Qilafi
brooke@qilafipr.com